

motorola edge 50 neo Service BOM for EU Market



Version 1.5



Product Summary	
Market Name	motorola edge 50 neo
Model Name	XT2409-X
Color	GRISAILLE/POINCIANA/LATTE/NAUTICAL BLUE

Model Summary	
Product	Technology
XT2409-1	EMEA,8+256/12+512,DS,pSIM+Esim

Revision History

Rev. No.	Changed Date	Change/Action	Owner
V1.5	07/25/2024	First release.	SVCPE@lenovo.com

Main Exploded View

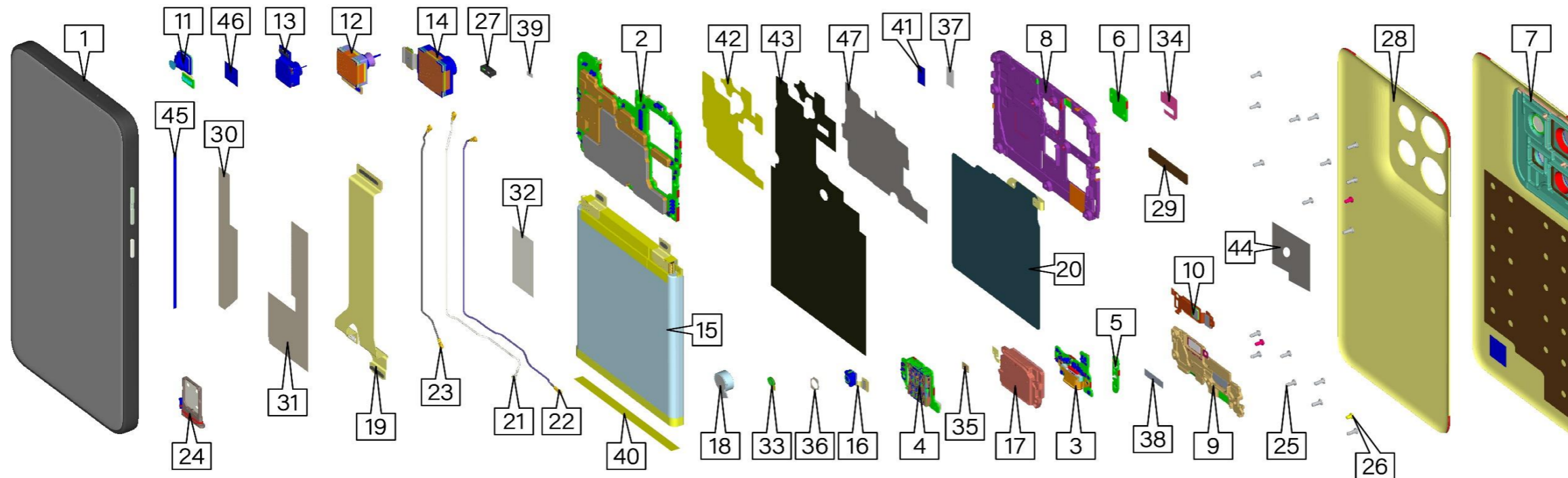

Parts List

Exploded Item Number	Commodity (Category)	Region/Carrier	Color	P/N	User Friendly Description	Qty	Pre-tax price(€)	Remark
1	TP LCM Ass'y	EU	GRISAILLE	5D68C28368	Display Assy Grisaille	1		
		EU	POINCIANA	5D68C28369	Display Assy Poinciana	1		
		EU	LATTE	5D68C28370	Display Assy Latte	1		
		EU	NAUTICAL BLUE	5D68C28371	Display Assy Nautical Blue	1		
3	Sub Board	EU	Com	5P68C28377	Sub Board USB-C	1		
4	Small Board	EU	Com	5P68C28378	SIM Board	1		
5	Small Board	EU	Com	5P68C28379	RF ANT Board	1		
6	Small Board	EU	Com	5P68C28380	Flash Board	1		
7	Mechanical Parts	EU	GRISAILLE	5S58C28381	Battery Cover Assy Grisaille	1		
		EU	POINCIANA	5S58C28382	Battery Cover Assy Poinciana	1		
		EU	LATTE	5S58C28383	Battery Cover Assy Latte	1		
		EU	NAUTICAL BLUE	5S58C28384	Battery Cover Assy Nautical Blue	1		
8	Mechanical Parts	EU	Com	5S58C28385	Top Bracket Assy	1		
9	Mechanical Parts	EU	Com	S948E32557	Bottom Bracket	1		
10	Frame	EU	Com	S948E32338	Fingerprint Sensor Bracket	1		
11	Camera	EU	Com	SC28D99143	Front Camera 32MP	1		
12	Camera	EU	Com	SC28D97301	3X Tele Rear Camera 10MP	1		
13	Camera	EU	Com	SC28E30280	Wide Rear Camera 13MP	1		
14	Camera	EU	Com	SC28E19562	Main Rear Camera 50MP	1		
15	Battery	EU	Com	SB18E22013	Battery 4300mAh	1		
16	FPS	EU	Com	SC98D33432	Fingerprint Sensor	1		
17	Speaker	EU	Com	S938E32281	Speaker	1		
18	Vibrator	EU	Com	S948E32324	Vibrator	1		
19	FPC	EU	Com	S938E32278	Main FPC	1		
20	Antenna	EU	Com	S928E32524	Wireless Charging Module	1		
21	Cable	EU	Com	S948E32345	RF Cable White	1		
22	Cable	EU	Com	S948E32346	RF Cable Black	1		
23	Cable	EU	Com	S948E32347	RF Cable Blue	1		
24	Metal	EU	GRISAILLE	S948E32319	Single SIM Tray Grisaille	1		
		EU	POINCIANA	S948E32321	Single SIM Tray Poinciana	1		
		EU	LATTE	S948E41920	Single SIM Tray Latte	1		
		EU	NAUTICAL BLUE	S948E45431	Single SIM Tray Nautical Blue	1		
25	Screw	EU	Com	S948E41911	Screw M1.4x3.5-16	17		
26	Screw	EU	Com	S948E32544	Screw	1		
27	Rubber	EU	Com	S948E32308	Sensor Grommet	1		
28	Adhesive	EU	Com	S948C28389	Battery Cover Adhesive	1		
29	Adhesive	EU	Com	S948C28390	Top Bracket Adhesive	1		
30	Adhesive	EU	Com	S948C28391	Battery Adhesive Left	1		
31	Adhesive	EU	Com	S948C28392	Battery Adhesive Right	1		
32	Adhesive	EU	Com	S948C28393	Main FPC Adhesive	1		
33	Adhesive	EU	Com	S948C28394	Vibrator Adhesive	1		
34	Adhesive	EU	Com	S948C28395	Flash Board Adhesive	1		
35	Adhesive	EU	Com	S948C28396	Speaker Box FPC Adhesive	1		
36	Adhesive	EU	Com	S948C28397	FOD Adhesive	1		
38	Adhesive	EU	Com	S948E37417	RF Cable Fixed Adhesive	1		
39	Gasket	EU	Com	S948E44878	Sensor Foam	1		
40	Gasket	EU	Com	S948E32527	Battery Buffer Foam	1		
41	Consumable	EU	Com	S948E32297	Main Rear Camera 50MP BTB Spacer	1		
42	Consumable	EU	Com	S948E32328	Main PCBA Bottom Conductive Copper Foil	1		
43	Consumable	EU	Com	S948E32329	Main PCBA Bottom Heat Dissipation Graphite	1		
44	Consumable	EU	Com	S948E45425	Speaker Box Heat Dissipation Graphite	1		
45	Consumable	EU	Com	S948E32298	RF Cable Mylar	1		
/	Consumable	EU	Com	S948E48842	SIM Board Shield Mylar	1		
/	Label	EU	Com	S948C48972	Water Detection Label	3		

Included in repair kit

DISCLAIMER & WARNING

INFORMATION CONTAINED IN THIS DOCUMENT IS PROPRIETARY AND CONFIDENTIAL AND SHOULD NOT BE COPIED, DISTRIBUTED OR REPRODUCED IN WHOLE OR IN PART, OR DISCLOSED IN ANY MANNER TO ANY THIRD PARTY WITHOUT THE PRIOR WRITTEN CONSENT OF MOTOROLA. ALL CONFIDENTIAL INFORMATION REMAINS THE PROPERTY OF MOTOROLA. EXCEPT FOR THE RIGHT TO ACCESS AND USE THIS CONFIDENTIAL INFORMATION IN FURTHERANCE OF THE REPAIR OF YOUR PERSONAL DEVICE, NO LICENSE OR OTHER RIGHT TO USE THIS CONFIDENTIAL INFORMATION OR TO MOTOROLA'S INTELLECTUAL PROPERTY IS GRANTED OR IMPLIED.

MOTOROLA IS NOT LIABLE FOR ANY DAMAGE OR DEFECT DETERMINED TO BE CAUSED BY A NON-AUTHORIZED SERVICE PROVIDER, SELF-REPAIR OR OTHER NON-PROFESSIONAL REPAIR OF THE DEVICE. SUCH DAMAGE OR DEFECT IS NOT COVERED BY THE WARRANTY. MOTOROLA IS NOT LIABLE FOR ANY RESULTING INJURY (INCLUDING DEATH) OR DEVICE SAFETY ISSUE CAUSED BY SUCH REPAIRS.

THIS DOCUMENT INCLUDES TECHNICAL INSTRUCTIONS FOR REPLACING GENUINE MOTOROLA PARTS AND IS INTENDED FOR INDIVIDUAL TECHNICIANS WITH KNOWLEDGE, EXPERIENCE, AND THE TOOLS REQUIRED TO REPAIR ELECTRONIC DEVICES.

READ THE ENTIRE DOCUMENT FIRST. IF YOU ARE NOT COMFORTABLE PERFORMING THE REPAIRS AS INSTRUCTED IN THIS DOCUMENT, DO NOT PROCEED.

FAILURE TO FOLLOW THE REPAIR INSTRUCTIONS OR TO USE AUTHENTIC/GENUINE PARTS OR PROPER TOOLS MAY CAUSE FIRE OR OTHER SAFETY ISSUES AND COULD LEAD TO PERSONAL INJURY (INCLUDING DEATH).

FAILURE TO FOLLOW THE REPAIR INSTRUCTIONS OR TO USE AUTHENTIC/GENUINE PARTS OR PROPER TOOLS MAY DAMAGE THE DEVICE OR COMPROMISE THE DEVICE'S FUNCTIONALITY, WATER RESISTANCE OR PERFORMANCE.

BY ACCESSING THIS DOCUMENT, RECIPIENT ACKNOWLEDGES, ACCEPTS AND AGREES TO THE FOREGOING.

© 2024, Motorola Mobility LLC

