

motorola edge 50 Service BOM for EU Market



Version 2.0



Product Summary	
Market Name	motorola edge 50
Model Name	XT2407-X
Color	STEEL WOOL/JASPER/PEACH FUZZ

Model Summary	
Product	Technology
XT2407-1	APEM+EU, 12+512, DS, P+E

Revision History

Rev. No.	Changed Date	Change/Action	Owner
V2.0	09/24/2024	First release.	SVCPE@lenovo.com

Main Exploded View

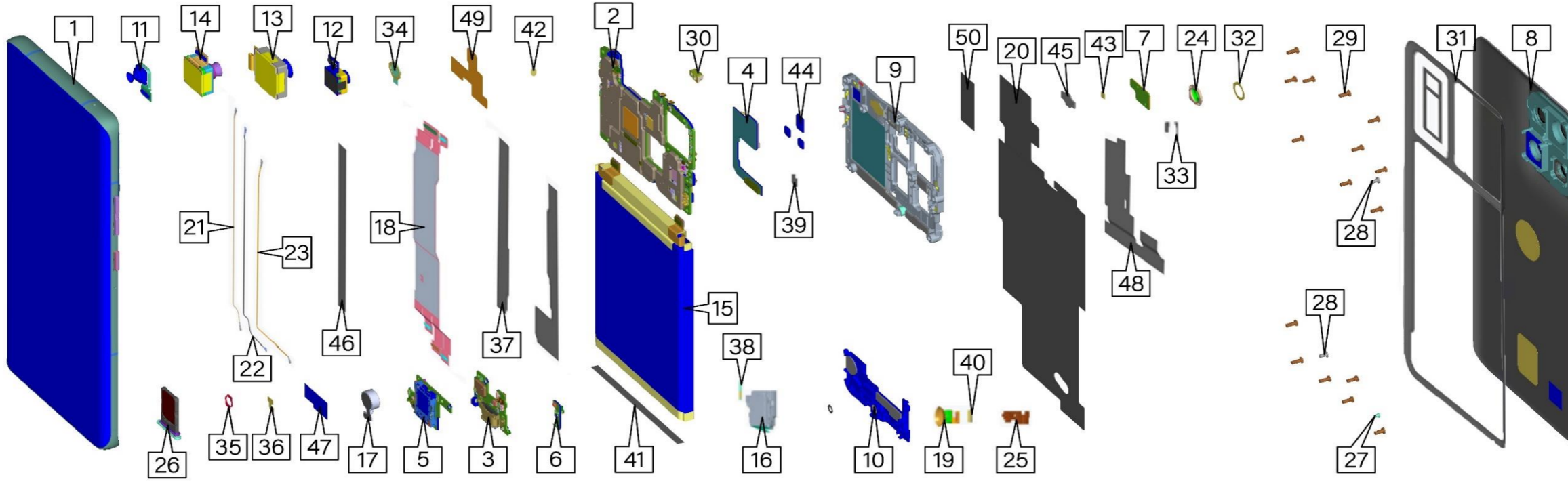

Parts List

Exploded Item Number	Commodity (Category)	Region/Carrier	Color	P/N	User Friendly Description	Qty	Pre-tax price(€)	Remark
1	TP LCM Ass'y	EU	STEEL WOOL	5D68C24914	Display Assy Steel Wool	1		
		EU	JASPER	5D68C24915	Display Assy Jasper	1		
		EU	PEACH FUZZ	5D68C24916	Display Assy Peach Fuzz	1		
3	Sub Board	EU	Com	5P68C24920	Sub Board USB-C	1		
4	Small Board	EU	Com	5P68C24921	Stack Board ST54K lite P+E	1		
5	Small Board	EU	Com	5P68C24922	SIM Board P+E	1		
6	Small Board	EU	Com	5P68C24923	RF ANT Board	1		
7	Small Board	EU	Com	5P68C24924	Flash Board	1		
8	Mechanical Parts	EU	STEEL WOOL	5S58C24925	Inlay Steel Wool	1		
		EU	JASPER	5S58C24926	Inlay Jasper	1		
		EU	PEACH FUZZ	5S58C24927	Inlay Peach Fuzz	1		
9	Mechanical Parts	EU	Com	SA38E22279	Top Bracket	1		
10	Mechanical Parts	EU	Com	SA38E22281	Bottom Bracket	1		
11	Camera	EU	Com	SC28E30503	Front Camera 32MP	1		
12	Camera	EU	Com	SC28D97301	Wide Rear Camera 10MP	1		
13	Camera	EU	Com	SC28E18569	Main Rear Camera 50MP	1		
14	Camera	EU	Com	SC28E30280	3X Tele Rear Camera 13MP	1		
15	Battery	EU	Com	SB18E18871	Battery 5000mAh	1		
16	Speaker	EU	Com	SSB8E22653	Speaker	1		
17	Vibrator	EU	Com	SM78C67497	Vibrator	1		
18	FPC	EU	Com	SP68E21403	Main FPC	1		
19	FPS	EU	Com	SC98D59607	Fingerprint Sensor	1		
20	Antenna	EU	Com	SA38E26024	Wireless Charging Module	1		
21	Cable	EU	Com	SC18E22327	RF Cable White	1		
22	Cable	EU	Com	SC18E22328	RF Cable Black	1		
23	Cable	EU	Com	SC18E22329	RF Cable Grey	1		
24	Lens	EU	Com	SL98E22317	Flash Lens	1		
25	Frame	EU	Com	SM88E22313	FOD Bracket	1		
26	Metal	EU	STEEL WOOL	SMO8E22288	Single SIM Tray Steel Wool	1		
		EU	JASPER	SMO8E22290	Single SIM Tray Jasper	1		
		EU	PEACH FUZZ	SMO8E22292	Single SIM Tray Peach Fuzz	1		
27	Screw	EU	Com	SM88D66034	Screw_M1P2_1P55_H03_CROSS	1		
28	Screw	EU	Com	SM88C84142	Screw M1.4x0.30x2.5mm	2		
29	Screw	EU	Com	SM88D59907	Screw Black M1.4x0.30x3.6mm	15		
30	Rubber	EU	Com	SMO8E45644	Sensor Rubber	1		
31	Adhesive	EU	Com	5D78C24908	Inlay Adhesive	1		
32	Adhesive	EU	Com	5D78C24909	Flash Lens Adhesive	1		
33	Adhesive	EU	Com	5D78C24910	Flash Board Adhesive	1		
34	Adhesive	EU	Com	5D78E22216	Front Camera Adhesive	1		
35	Adhesive	EU	Com	5D78E22222	FOD Adhesive	1		
36	Adhesive	EU	Com	5D78E28523	Speaker Box FPC Adhesive	1		
37	Adhesive	EU	Com	5D78E22246	Battery Adhesive	1		
38	Adhesive	EU	Com	5D78E29729	USB Board Adhesive	1		
39	Adhesive	EU	Com	5D78E27700	Stack Board Adhesive	1		
40	Gasket	EU	Com	5D78E22240	FOD Bracket Foam	1		
41	Gasket	EU	Com	5D78E22243	Battery Buffer Foam	1		Included in repair kit
42	Gasket	EU	Com	5D78D75832	Mic Mesh Foam	2		
43	Gasket	EU	Com	5D78E22248	Flash & Stack Board Conductive Foam	2		
44	Gasket	EU	Com	5D78E22251	Rear Camera Connector Foam	1		
45	Gasket	EU	Com	5D78E22235	Receiver Supporting Foam	1		
46	Consumable	EU	Com	5D78E22247	RF Cable Mylar	1		
47	Consumable	EU	Com	5D78E22241	FOD Mylar	1		
48	Consumable	EU	Com	SH48E22274	PMU Heat Dissipation Graphite	1		
49	Consumable	EU	Com	SH48E22276	Front Camera 32MP Heat Dissipation Graphite	1		
50	Consumable	EU	Com	SH48E22275	Receiver Heat Dissipation Graphite	1		
/	Screw	EU	Com	SM88D40348	Screw M1.4x3	1		
/	Adhesive	EU	Com	5D78E39525	RF Cable Adhesive	1		
/	Consumable	EU	Com	5D78E44522	Side Key Silicone Foam	1		
/	Consumable	EU	Com	5D78E10859	Speaker Mesh for IP68	1		
/	Label	EU	Com	5D78C48847	Water Detection Label	3		

DISCLAIMER & WARNING

INFORMATION CONTAINED IN THIS DOCUMENT IS PROPRIETARY AND CONFIDENTIAL AND SHOULD NOT BE COPIED, DISTRIBUTED OR REPRODUCED IN WHOLE OR IN PART, OR DISCLOSED IN ANY MANNER TO ANY THIRD PARTY WITHOUT THE PRIOR WRITTEN CONSENT OF MOTOROLA. ALL CONFIDENTIAL INFORMATION REMAINS THE PROPERTY OF MOTOROLA. EXCEPT FOR THE RIGHT TO ACCESS AND USE THIS CONFIDENTIAL INFORMATION IN FURTHERANCE OF THE REPAIR OF YOUR PERSONAL DEVICE, NO LICENSE OR OTHER RIGHT TO USE THIS CONFIDENTIAL INFORMATION OR TO MOTOROLA'S INTELLECTUAL PROPERTY IS GRANTED OR IMPLIED.

MOTOROLA IS NOT LIABLE FOR ANY DAMAGE OR DEFECT DETERMINED TO BE CAUSED BY A NON-AUTHORIZED SERVICE PROVIDER, SELF-REPAIR OR OTHER NON-PROFESSIONAL REPAIR OF THE DEVICE. SUCH DAMAGE OR DEFECT IS NOT COVERED BY THE WARRANTY. MOTOROLA IS NOT LIABLE FOR ANY RESULTING INJURY (INCLUDING DEATH) OR DEVICE SAFETY ISSUE CAUSED BY SUCH REPAIRS.

THIS DOCUMENT INCLUDES TECHNICAL INSTRUCTIONS FOR REPLACING GENUINE MOTOROLA PARTS AND IS INTENDED FOR INDIVIDUAL TECHNICIANS WITH KNOWLEDGE, EXPERIENCE, AND THE TOOLS REQUIRED TO REPAIR ELECTRONIC DEVICES.

READ THE ENTIRE DOCUMENT FIRST. IF YOU ARE NOT COMFORTABLE PERFORMING THE REPAIRS AS INSTRUCTED IN THIS DOCUMENT, DO NOT PROCEED.

FAILURE TO FOLLOW THE REPAIR INSTRUCTIONS OR TO USE AUTHENTIC/GENUINE PARTS OR PROPER TOOLS MAY CAUSE FIRE OR OTHER SAFETY ISSUES AND COULD LEAD TO PERSONAL INJURY (INCLUDING DEATH).

FAILURE TO FOLLOW THE REPAIR INSTRUCTIONS OR TO USE AUTHENTIC/GENUINE PARTS OR PROPER TOOLS MAY DAMAGE THE DEVICE OR COMPROMISE THE DEVICE'S FUNCTIONALITY, WATER RESISTANCE OR PERFORMANCE.

BY ACCESSING THIS DOCUMENT, RECIPIENT ACKNOWLEDGES, ACCEPTS AND AGREES TO THE FOREGOING.

© 2024, Motorola Mobility LLC

