

Moto g55 5G Service BOM for EU Market



Version 1.5



Product Summary	
Market Name	Moto g55 5G
Model Name	XT2435-X
Color	DARKEST SPRUCE/DESERT SAGE/ROSE SORBET

Model Summary	
Product	Technology
XT2435-2	EU/AP, 8+256/4+128/12+256, DS, pSIM+eSIM

Revision History

Rev. No.	Changed Date	Change/Action	Owner
V1.5	09/03/2024	First release.	SVCPE@lenovo.com

Main Exploded View

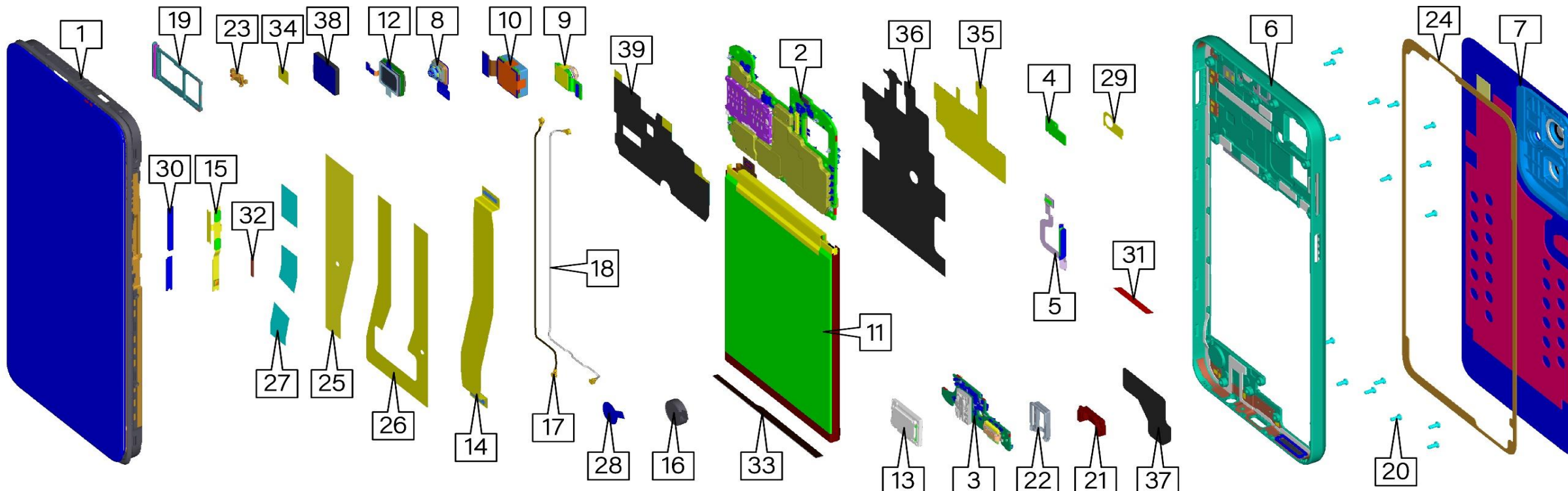

Parts List

Exploded Item Number	Commodity (Category)	Region/Carrier	Color	P/N	User Friendly Description	Qty	Pre-tax price(€)	Remark
1	TP LCM Ass'y	EU	Com	5D68C28432	Display Assy	1		
3	Sub Board	EU	Com	5P68C28436	Sub Board USB-C	1		
4	Small Board	EU	Com	5P68C28437	Flash Board	1		
5	FPS	EU	DARKEST SPRUCE	5S58C28438	Fingerprint Sensor Darkest Spruce	1		
		EU	DESERT SAGE	5S58C28439	Fingerprint Sensor Desert Sage	1		
		EU	ROSE SORBET	5S58C28440	Fingerprint Sensor Rose Sorbet	1		
6	Mechanical Parts	EU	DARKEST SPRUCE	5S58C28444	Middle Frame Darkest Spruce	1		
		EU	DESERT SAGE	5S58C28445	Middle Frame Desert Sage	1		
		EU	ROSE SORBET	5S58C28446	Middle Frame Rose Sorbet	1		
7	Mechanical Parts	EU	DARKEST SPRUCE	5S58C28447	Battery Cover Darkest Spruce PMMA	1		
		EU	DESERT SAGE	5S58C28448	Battery Cover Desert Sage	1		
		EU	ROSE SORBET	5S58C28449	Battery Cover Rose Sorbet	1		
8	Camera	EU	Com	SC28D55366	Front Camera 16MP	1		
9	Camera	EU	Com	SC28E30571	Macro Rear Camera 8MP	1		
10	Camera	EU	Com	SC28E07339	Main Rear Camera 50MP	1		
11	Battery	EU	Com	SB18E40223	Battery 5000mAh	1		
12	Receiver	EU	Com	S938D91994	Receiver	1		
13	Speaker	EU	Com	S938D91995	Speaker	1		
14	FPC	EU	Com	S948E04388	Main FPC Molex	1		
15	FPC	EU	Com	S948E04391	Side Key FPC	1		
16	Vibrator	EU	Com	S948D91993	Vibrator	1		
17	Cable	EU	Com	S948D92019	RF Cable Black	1		
18	Cable	EU	Com	S948D92020	RF Cable White	1		
19	Metal	EU	DARKEST SPRUCE	S948E40607	Single SIM Tray Darkest Spruce	1		
		EU	DESERT SAGE	S948E40608	Single SIM Tray Desert Sage	1		
		EU	ROSE SORBET	S948E40609	Single SIM Tray Rose Sorbet	1		
20	Screw	EU	Com	S948E03991	Screw Black M1.4x3.2xT5Black	16		
21	Rubber	EU	Com	S948D92030	USB Grommet	1		
22	Rubber	EU	Com	S948D92029	Audiojack Grommet	1		
23	Rubber	EU	Com	S948D92028	Sensor Grommet	1		
24	Adhesive	EU	DARKEST SPRUCE	5D78C28715	Battery Cover PMMA Adhesive	1		
		EU	DESERT SAGE/ROSE SORBET	5D78C28716	Battery Cover PU Adhesive	1		
25	Adhesive	EU	Com	5D78C23270	Battery Adhesive Left	1		
26	Adhesive	EU	Com	5D78C23271	Battery Adhesive Right	1		
27	Adhesive	EU	Com	5D78C23272	Main FPC Adhesive	1		
28	Adhesive	EU	Com	5D78C23273	Vibrator Adhesive	1		
29	Adhesive	EU	Com	5D78C23274	Flash Board Adhesive	1		
30	Adhesive	EU	Com	5D78C23275	Side Key Adhesive	1		
31	Adhesive	EU	Com	S948E01437	Inlay Bottom Small Adhesive	1		
32	Gasket	EU	Com	S948E01436	Side Key Seal Foam	1		Included in repair kit
33	Gasket	EU	Com	S948D92027	Battery Buffer Foam	1		
34	Consumable	EU	Com	S948D92033	Macro Rear Camera Conductive Cloth	1		
35	Consumable	EU	Com	S948D92034	Main PCBA Bottom Conductive Copper Foil	1		
36	Consumable	EU	Com	S948E23260	Main PCBA Bottom Heat Dissipation Graphite	1		
37	Consumable	EU	Com	S948E40622	Speaker Box Heat Dissipation Graphite	1		
38	Consumable	EU	Com	S948E00586	Main Rear Camera 50MP AL Block	1		
/	Adhesive	EU	DARKEST SPRUCE	S948E48171	Middle Frame Anti-shock Adhesive PMMA	1		
/	Adhesive	EU	DESERT SAGE/ROSE SORBET	S948E48821	Middle Frame Anti-shock Adhesive PU	1		
/	Consumable	EU	Com	S948E48170	Main PCBA Bottom Shield Foam	2		
/	Consumable	EU	Com	S948E52961	SIM Tray Waterproof Mylar	2		
/	Label	EU	Com	S948C48972	Water Detection Label	3		

DISCLAIMER & WARNING

INFORMATION CONTAINED IN THIS DOCUMENT IS PROPRIETARY AND CONFIDENTIAL AND SHOULD NOT BE COPIED, DISTRIBUTED OR REPRODUCED IN WHOLE OR IN PART, OR DISCLOSED IN ANY MANNER TO ANY THIRD PARTY WITHOUT THE PRIOR WRITTEN CONSENT OF MOTOROLA. ALL CONFIDENTIAL INFORMATION REMAINS THE PROPERTY OF MOTOROLA. EXCEPT FOR THE RIGHT TO ACCESS AND USE THIS CONFIDENTIAL INFORMATION IN FURTHERANCE OF THE REPAIR OF YOUR PERSONAL DEVICE, NO LICENSE OR OTHER RIGHT TO USE THIS CONFIDENTIAL INFORMATION OR TO MOTOROLA'S INTELLECTUAL PROPERTY IS GRANTED OR IMPLIED.

MOTOROLA IS NOT LIABLE FOR ANY DAMAGE OR DEFECT DETERMINED TO BE CAUSED BY A NON-AUTHORIZED SERVICE PROVIDER, SELF-REPAIR OR OTHER NON-PROFESSIONAL REPAIR OF THE DEVICE. SUCH DAMAGE OR DEFECT IS NOT COVERED BY THE WARRANTY. MOTOROLA IS NOT LIABLE FOR ANY RESULTING INJURY (INCLUDING DEATH) OR DEVICE SAFETY ISSUE CAUSED BY SUCH REPAIRS.

THIS DOCUMENT INCLUDES TECHNICAL INSTRUCTIONS FOR REPLACING GENUINE MOTOROLA PARTS AND IS INTENDED FOR INDIVIDUAL TECHNICIANS WITH KNOWLEDGE, EXPERIENCE, AND THE TOOLS REQUIRED TO REPAIR ELECTRONIC DEVICES.

READ THE ENTIRE DOCUMENT FIRST. IF YOU ARE NOT COMFORTABLE PERFORMING THE REPAIRS AS INSTRUCTED IN THIS DOCUMENT, DO NOT PROCEED.

FAILURE TO FOLLOW THE REPAIR INSTRUCTIONS OR TO USE AUTHENTIC/GENUINE PARTS OR PROPER TOOLS MAY CAUSE FIRE OR OTHER SAFETY ISSUES AND COULD LEAD TO PERSONAL INJURY (INCLUDING DEATH).

FAILURE TO FOLLOW THE REPAIR INSTRUCTIONS OR TO USE AUTHENTIC/GENUINE PARTS OR PROPER TOOLS MAY DAMAGE THE DEVICE OR COMPROMISE THE DEVICE'S FUNCTIONALITY, WATER RESISTANCE OR PERFORMANCE.

BY ACCESSING THIS DOCUMENT, RECIPIENT ACKNOWLEDGES, ACCEPTS AND AGREES TO THE FOREGOING.

© 2024, Motorola Mobility LLC

